

Шариковые краны и вакуумные вентили

Двухкамерный шариковый кран резьба/резьба
port ball valve

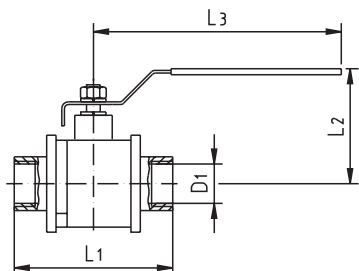

Ду	D1	L1	L2	L3	Вес [кг]
1/4"	G 1/4"	50.8	56	98	0.26
3/8"	G 3/8"	50.8	58	98	0.25
1/2"	G 1/2"	58	59	98	0.31
3/4"	G 3/4"	65.5	62	123	0.46
1"	G 1"	78.7	77.5	145	0.77
1 1/4"	G 1 1/4"	90	83.5	145	1.12
1 1/2"	G 1 1/2"	105	101.5	188	1.74
2"	G 2"	124	110.5	188	2.65
2 1/2"	G 2 1/2"	146.2	138	247	5.37
3"	G 3"	163.7	146	247	7.43

Трехкамерный шариковый кран резьба/резьба
port ball valve

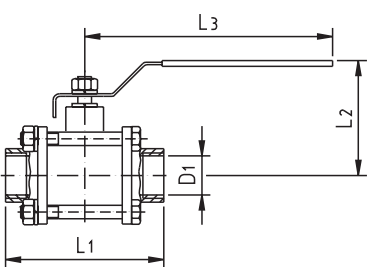

Ду	D1	L1	L2	L3	Вес [кг]
1/4"	G 1/4"	64.5	60	100	0.39
3/8"	G 3/8"	64.5	60	100	0.41
1/2"	G 1/2"	65	63	100	0.53
3/4"	G 3/4"	77	65	125	0.79
1"	G 1"	89	80	149	1.2
1 1/4"	G 1 1/4"	103	85	149	1.86
1 1/2"	G 1 1/2"	115	100	190	2.57
2"	G 2"	134	108	190	3.89
2 1/2"	G 2 1/2"	164	136	250	8.3
3"	G 3"	190	146	250	12.25

Трехкамерный шариковый кран сварка/сварка
port ball valve

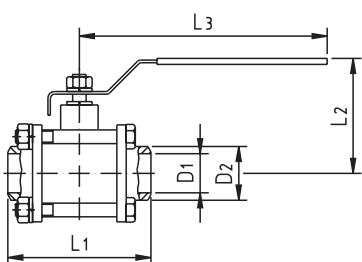

Ду	D1	D2	L1	L2	L3	Вес [кг]
1/4"	11.6	17	64.5	60	100	0.37
3/8"	12.7	19,5	64.5	60	100	0.39
1/2"	15	22	65	63	100	0.53
3/4"	20	27,5	77	65	125	0.76
1"	25	34	89	80	149	1.15
1 1/4"	32	41,5	103	85	149	1.77
1 1/2"	38	48,6	115	100	190	2.43
2"	50	62	134	108	190	3.8
2 1/2"	65	76,3	164	136	250	8.2
3"	80	92	190	146	250	12.6
4"	100	115	115	182	290	18.5