

Diaphragm Valve Type 514, 515, 517, 519

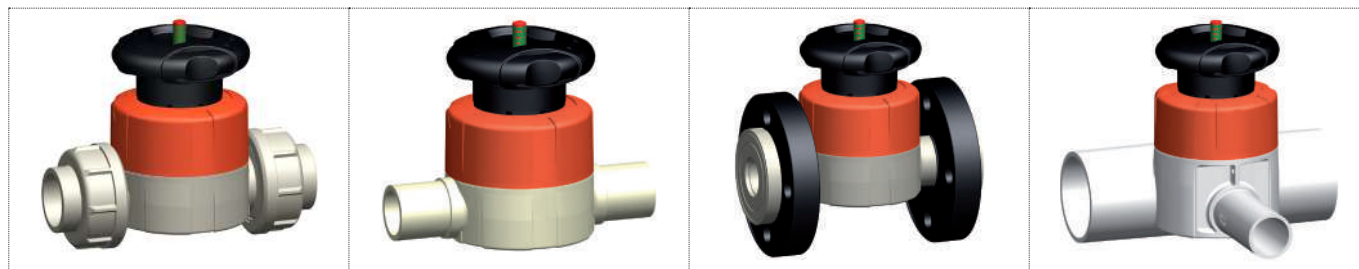

Type 514
Radial installation and removal

Type 515
Spigot version

Type 517
Flange version

Type 519
Branched valve

Product description

Diaphragm valves of the Type 5 series from GF Piping Systems are used for regulating, closing, controlling and monitoring volume flows. Especially when transporting contaminated, aggressive or abrasive media, this Type of valve has decisive advantages thanks to its simple function and optimized construction. Only the valve body and diaphragm come into contact with the medium.

The valve is suitable for use with gases and liquids and can be used in any location and drained completely.

Unlike other Valve Types, no pressure surges can be caused by closing the diaphragm valve. GF Piping Systems offers this Valve Type as a manually operated valve and automatic valve.

Applications

- Chemical process industry
- Microelectronics
- Water treatment
- Cooling
- Control applications

Benefits/features

- Full plastic valve without metal screws
- No corrosion due to aggressive media/environment
- Constant leak-tightness in the event of changes in temperature without tightening screws
- Plastic-appropriate, highly stable connection of upper part and valve body by means of a buttress thread
- Maximum flow and linear characteristic curves for easier control
- Diaphragm geometry for longer service life
- Integrated handwheel locking device
- Valve is free of dead space, sealing web lies close to the pipe wall

Flow media

Contaminated, solid or ultrapure media

Technical data

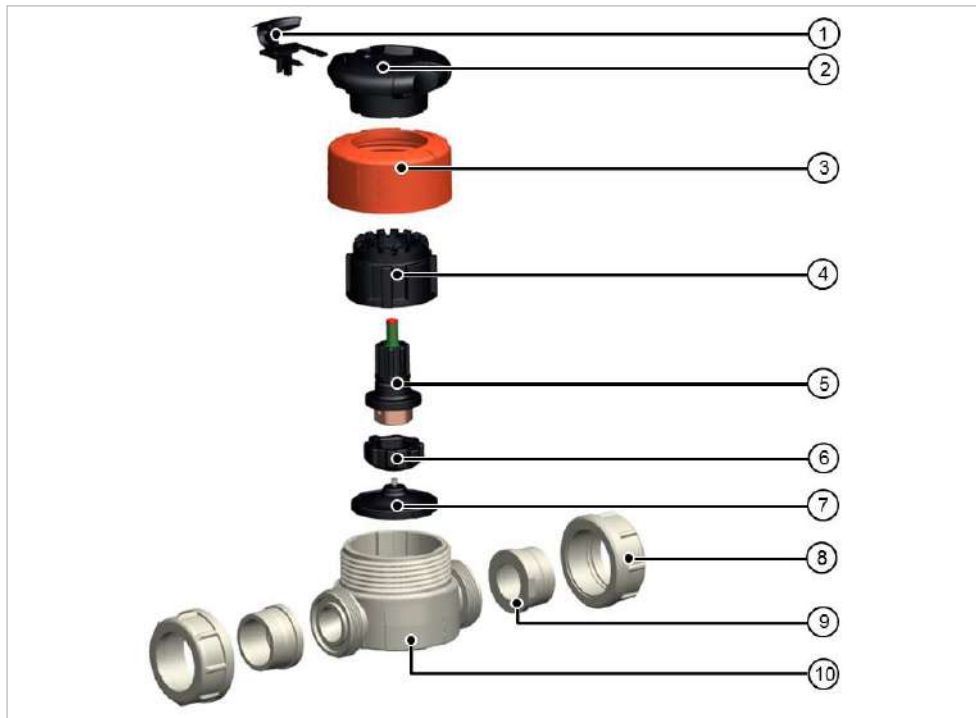

- ① Handwheel locking device
- ② Handwheel
- ③ Central housing nut
- ④ Inner housing
- ⑤ Spindle assembly incl. diaphragm holder
- ⑥ Pressure piece
- ⑦ Diaphragm
- ⑧ Coupling nut
- ⑨ Insert
- ⑩ Valve body

| Specification | | |
|-----------------------------------|---|---|
| Dimensions | Type 514 | d20/DN15 – d63/DN50, ½" - 2" |
| | Type 517 | d20/DN15 – d63/DN50, ½" - 2" |
| | Type 515 | d20/DN15 – d63/DN50, ½" - 2" |
| | Type 519 | d20/DN15 – d20/DN15, ½"; d160/DN150 – d63/DN50, 4" - 2" |
| Valve body materials | Type 514 | PVC-U, PVC-C, ABS, PP-H, PVDF, PVDF-HP |
| | Type 515 | PVC-U, PVC-C, ABS, PP-H, PP-N, PVDF, PVDF-HP |
| | Type 517 | PVC-U, PVC-C, PP-H, PVDF, PVDF-HP |
| | Type 519 | PP-H, PP-N, PVDF-HP |
| Housing nut materials | PPGF 30 for PN10 PPSGF40 for PN 16 (only for water applications) | |
| Gasket/diaphragm materials | EPDM, PTFE/EPDM, NBR,FKM (except Type 519), PTFE/FKM, FFKM | |
| Pressure levels | PN16 | PVC-U, PVDF, PVDF-HP (dependant from threaded bush) |
| | PN10 | PVC-U, PVC-C, ABS, PP-H, PP-N, PVDF, PVDF-HP |
| Actuation variants | Hand-operated Pneumatic (see Type DIASTAR) | |
| Connections | Type 514 | Screw connection with solvent cement sockets, threaded sockets, fusion sockets, butt fusion spigots |
| | Type 515 | Solvent cement spigot, socket fusion spigot, butt fusion spigot |
| | Type 517 | Fixed flange, backing flange |
| | Type 519 | 3-way valve with butt fusion spigot |
| Approvals | ACS, FDA, DIBt | |