

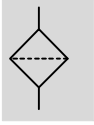

Vacuum filters VAF-DB

Technical data

FESTO

Function



-  - Temperature range
-5 ... +50 °C
-  - Operating pressure
-0.95 ... 0 bar



-  - Note
Only for use in open vacuum systems.

The vacuum filter is used to filter particles in the direction of suction. The filter cartridge is located in a transparent bowl so that the degree of

contamination of the filter cartridge can be identified. The filter cartridge can be replaced → 6.

General technical data				
Pneumatic connection		G $\frac{1}{4}$	G $\frac{3}{8}$	G $\frac{1}{2}$
Vacuum port		G $\frac{1}{4}$	G $\frac{3}{8}$	G $\frac{1}{2}$
Mounting position		Vertical		
Type of mounting		In-line installation Via wall/surface bracket → 6		
Grade of filtration	[μ m]	80		
Ejector pulse suitability	[bar]	≤7		
Max. tightening torque	[Nm]	8.7	15.3	20.5

Operating and environmental conditions	
Operating pressure	[bar] -0.95 ... 0
Note on operating pressure	Only for use in open vacuum systems
Operating medium	Compressed air to ISO 8573-1:2010 [7:-:-]
Ambient temperature	[°C] -5 ... +50

Materials	
Housing	PP reinforced
Bowl	PA
Filters	PE
Seals	Nitrile rubber
Note on materials	RoHS-compliant Contains PWIS (paint-wetting impairment substances)

Vacuum filters VAF-DB

Technical data

Standard flow rate q_n as a function of differential pressure Δp_{1-2}

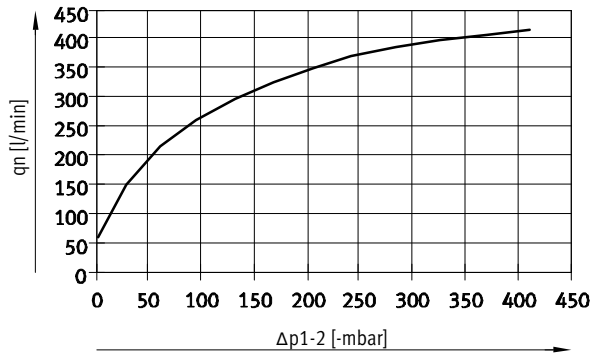

— VAF-DB-1/4

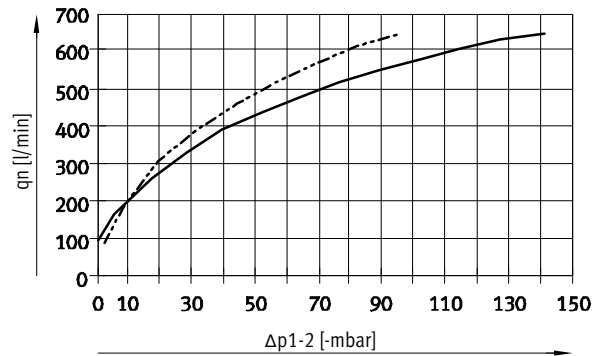

— VAF-DB-3/8
 - - - VAF-DB-1/2

Dimensions

Download CAD data → www.festo.com

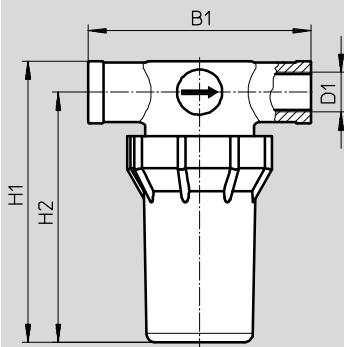

Ordering data

Connection	B1	H1	H2	Weight [g]	Part No.	Type
D1						
1/4	75	94.5	84.5	71	547261	VAF-DB-1/4
3/8	90.5	125	113	156	553140	VAF-DB-3/8
1/2	90.5	129	115	162	553141	VAF-DB-1/2